



545 Basket Road
Webster, NY 14580

Toll Free: 800.691.0292 | Local: 585.265.1990 | Fax: 585.265.6678

www.fastenersdirect.com
sales@fastenersdirect.com

REGULAR & DRIVE STYLE STEEL HOLLOW WALL ANCHORS

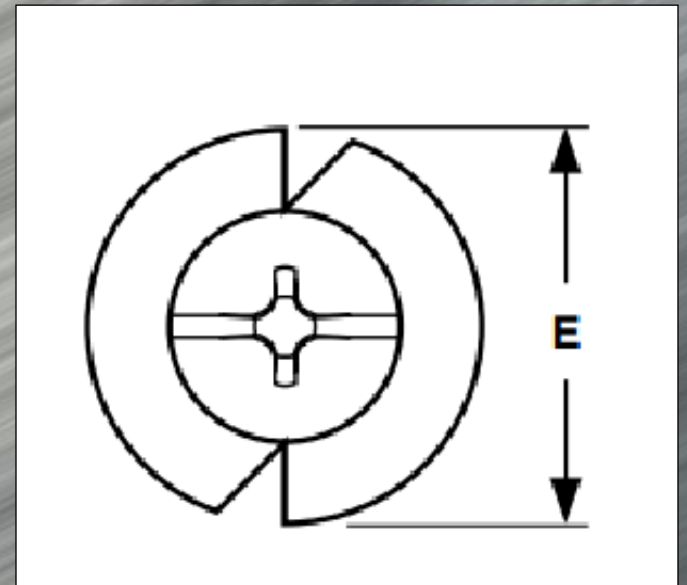
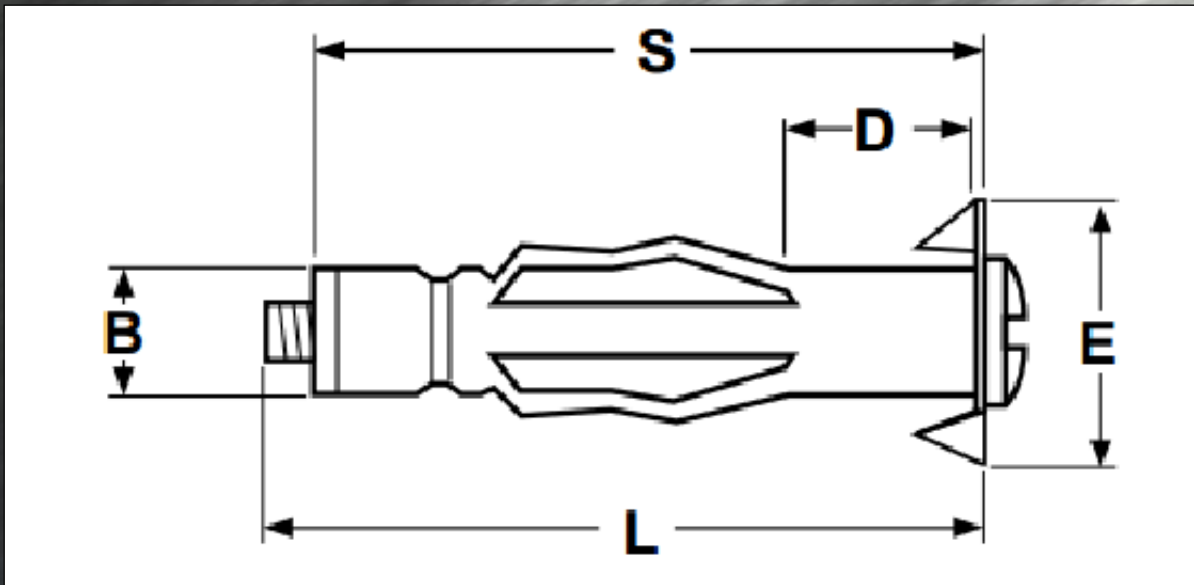



545 Basket Road
Webster, NY 14580

Toll Free: 800.691.0292 | Local: 585.265.1990 | Fax: 585.265.6678

www.fastenersdirect.com
sales@fastenersdirect.com

REGULAR & DRIVE STYLE STEEL HOLLOW WALL ANCHORS

B Notes Diameter	Screw Size		E	D	S	Grip Range		Performance in Plywood			Performance in Drywall		
	Anchor Size	Diam x L	Hole Size	Collar Di- am. Ref.	Sleeve Length Ref.	Overall Shell Length	Max	Min	Material Thick- ness Inches	Pull Out Lbs.	Shear Lbs.	Material Thick- ness Inches	Pullout Lbs.
1/8 Extra Short	6-32 x 1	5/16	1/2	3/16	25/32	1/4	1/16	1/8	110	100	-	-	-
								1/4	125	450			
1/8 Short	6-32 x 1-1/2	5/16	1/2	3/8	1-1/4	1/2	1/8	1/4	65	350	1/4	25	190
								1/2	300	425	1/2	90	165
1/8 Long	6-32 2	5/16	1/2	3/4	1-11/16	7/8	5/8	5/8	430	450	5/8	130	205
								7/8	450	450	7/8	145	
1/8 Extra Long	6-32 x 2-1/2	5/16	1/2	3/4	2-1/4	1-1/2	1-1/4	1-1/4	500	450	1-1/4	260	320
3/16 Short	10-24 x 2-1/4	3/8	5/8	3/8	2-1/16	5/8	1/8	1/4	65	550	1/4	25	230
								5/8	475	635	5/8	135	300
3/16 Long	10-24 x 2-3/4	3/8	5/8	7/8	2-9/16	1-3/16	5/8	5/8	500	640	5/8	135	305
								1-1/8	605	730	1-1/8	260	785
3/16 Extra Long	10-24 x 3-1/2	3/8	5/8	1-1/2	3-3/16	1-3/4	1-1/4	1-1/4	660	765	1-1/4	300	490



545 Basket Road
Webster, NY 14580

Toll Free: 800.691.0292 | Local: 585.265.1990 | Fax: 585.265.6678

www.fastenersdirect.com
sales@fastenersdirect.com

REGULAR & DRIVE STYLE STEEL HOLLOW WALL ANCHORS

B Notes Diameter	Screw Size		E	D	S	Grip Range		Performance in Plywood			Performance in Drywall		
	Anchor Size	Diam x L	Hole Size	Collar Di- am. Ref.	Sleeve Length Ref.	Overall Shell Length	Max	Min	Material Thick- ness Inches	Pull Out Lbs.	Shear Lbs.	Material Thick- ness Inches	Pullout Lbs.
1/4 Short	1/4-20 x 2-1/4	1/2	11/16	3/8	2-1/16	5/8	1/8	1/4	65	600	1/4	25	240
								5/8	500	850	5/8	140	300
1/4 Long	1/4-20 x 2-3/4	1/2	11/16	7/8	2-9/16	1-3/16	5/8	5/8	500	900	5/8	155	330
								1-1/8	720	1000	1-1/8	165	550
1/4 Extra Long	1/4-20 x 3-1/2	1/2	11/16	1-1/2	3-3/16	1-3/4	1-1/4	1-1/4	765	1220	1-1/4	200	575

DESCRIPTION: A three-piece fastener consisting of (1) a cylindrical expander shell with longitudinal sections of its shank removed--this design allows the shell to be pulled toward the head and form anchoring legs on the blind side of the assembly. The shell has a threaded opening at one end and a flanged collar at the opposite end with an opening sufficiently large enough to allow a screw to pass to the threaded opening. The flange of the collar has prongs which dig into the bearing surface at the front end of the assembly; (2) a combo-drive pan head screw; (3) either a fiber or steel flat washer.

APPLICATIONS/ADVANTAGES: Steel hollow wall anchors are considered to be light-duty anchors. They require a pre-drilled hole and may be used in drywall, sheetrock, plaster or paneling. When properly installed, they will not crack or crumble the wall material and resist vibration. The machine screw may be removed and inserted multiple times to accommodate an exchange of fixtures.

MATERIAL: Shell: AISI C1008 - 1010 or equivalent cold-rolled steel Screw: Carbon steel with a minimum tensile strength of 60,000 psi.

PULLOUT VALUES: Expansion sleeve hollow wall anchors shall not be removable or show evidence of failure when subjected to axially applied proof loads as specified in the above table. The safe working load is one-fourth the average pullout values listed above.

SHEAR STRENGTH: The safe working load is one-fourth the average shear values listed above.